

Prime Retail/Leisure Unit to Let

Unit 1, 23 London Road
Newark-on-Trent, Nottinghamshire, NG24 1TN



richard lucas property consultants

0161 241 7998

info@richardlucas.co.uk

www.richardlucas.co.uk

Unit 1, 23 London Road, Newark, Nottinghamshire

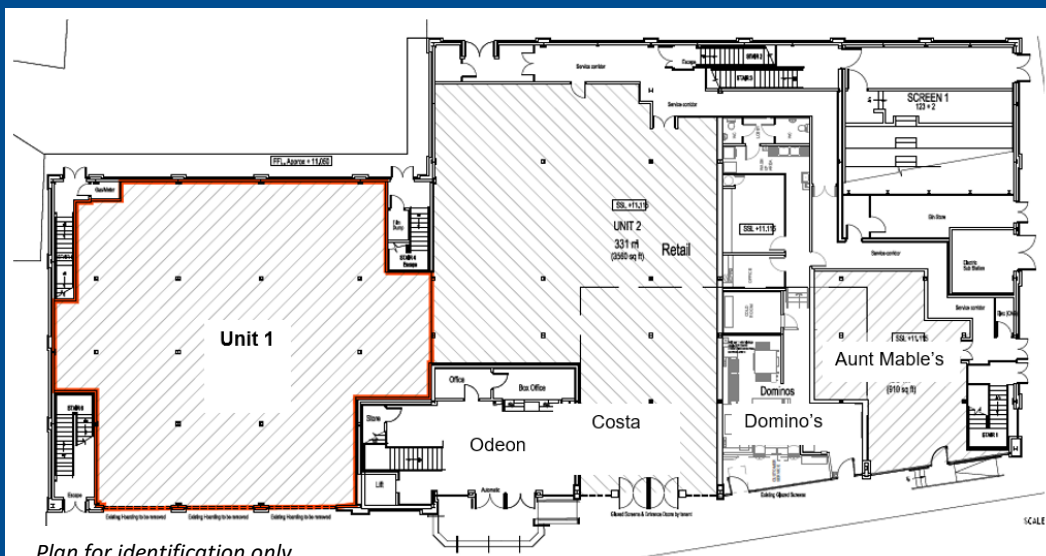

Plan for identification only

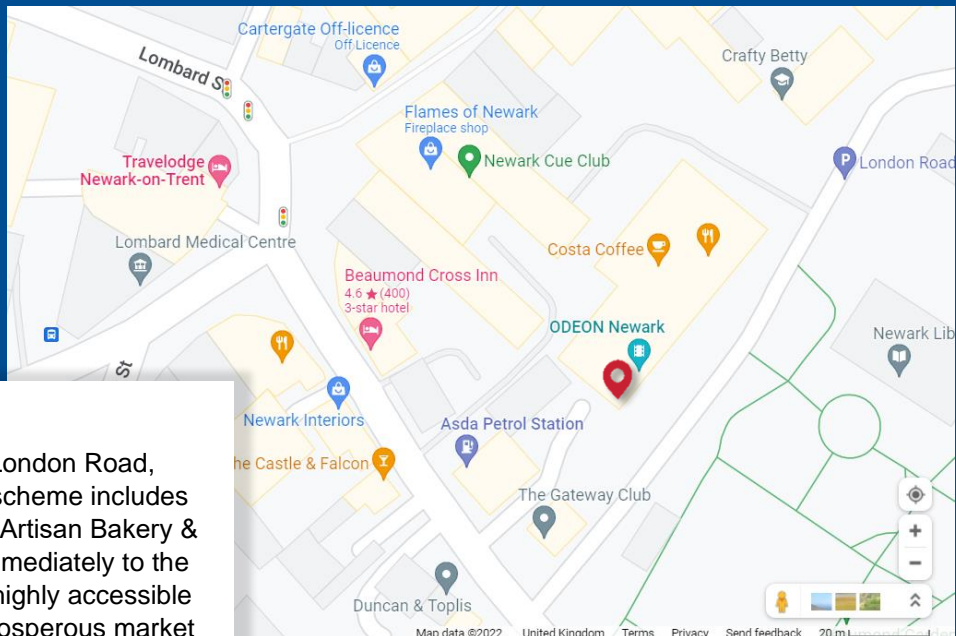

Location

Unit 1 forms part of the Odeon development off London Road, Newark. In addition to the 5 screen cinema, the scheme includes Costa Coffee, Domino's Pizza and Aunt Mable's Artisan Bakery & Tea Rooms. There is a pay & display car park immediately to the front with over 100 spaces. The development is highly accessible and close to Newark town centre. Newark is a prosperous market town, located just off the A1, with a population of 43,363 (2011 Census urban area) and 112,204 within 10 miles (CoStar).

Description

Unit 1 enjoys good prominence being the first unit on entering the car park from London Road. It has an approximate gross internal area of 3,765 sq ft (349.77 sq m).

Tenure

Leasehold on terms to be agreed.

Rent

On application.

Service Charge and EPC

A service charge is payable - details on application.
Energy Performance Certificate – Energy Rating: C

Business Rates

Rateable Value (2019): £42,000

It is recommended that interested parties make their own enquiries with the local rating authority to check the assessment and the rates payable by calling 01636 650000

Planning

It is the responsibility of the interested party to satisfy themselves that the appropriate planning consent is in place prior to committing to a new lease.

Viewing

Strictly by arrangement via:



Centurion House, 129 Deansgate, Manchester, M3 3WR

0161 241 7998

info@richardlucas.co.uk

www.richardlucas.co.uk

Richard Lucas Property Consultants Ltd for themselves, for any joint agents and for the vendors or lessors of this property whose agents they are give notice that: (i) the particulars are set out as a general outline only for the guidance of intending purchasers or lessees and do not constitute, nor constitute part of, an offer or contract; (ii) all descriptions, dimensions, floor areas, references to condition and necessary permissions for use and occupation, and other details, are given in good faith and are believed to be correct, but any intending purchasers or tenants should not rely on them as statements or representations of fact, but satisfy themselves by inspection or otherwise as to the correctness of each of them; (iii) no person in the employment of Messrs. Richard Lucas Property Consultants Ltd or any joint agents has authority to make or give any representations or warranty whatever in relation to this property; (iv) all rentals and prices are quoted exclusive of but may be liable to VAT. February 2023. Subject to Contract